

J. WILSON  
169-765  
165-1337

FAGAN, ET AL.  
198-102

I, a Notary Public of the County and State aforesaid, certify that Robert Barry Butler, a Registered Land Surveyor, personally appeared before me this day and acknowledged the execution of the foregoing instrument to be his act and deed and of legal stamp or seal, this 25<sup>th</sup> day of May 1995.  
Andrea C. Town  
Notary Public  
My commission expires: 12/14/97

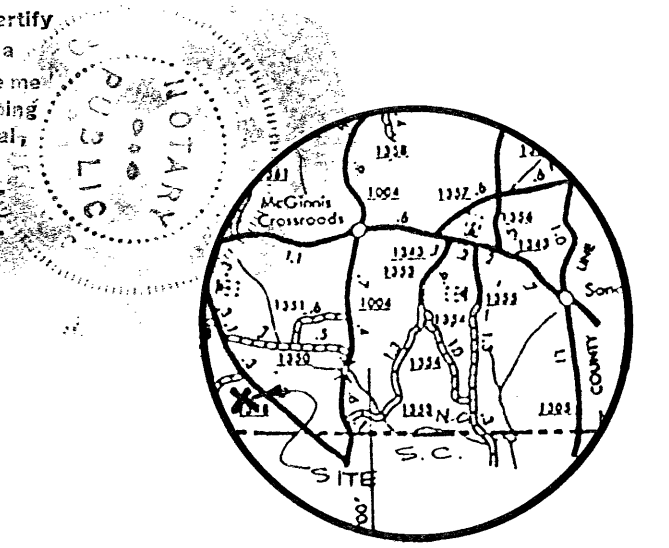

VICINITY MAP

NORTH CAROLINA, POLK COUNTY  
The foregoing is a true and correct copy of the original as recorded in Book 102, Page 102, and recorded in the Top in Book Card file C, Page 501.  
Kj m Wilson  
Reg. No. L-3033

Surveyor's Certificate: I, Robert Barry Butler, a Registered Land Surveyor for the State of North Carolina, County of Polk, do hereby certify that this map was drawn under my supervision and that the bearings and distances are true and correct as shown on the map. The area of the land surveyed is 32.96 acres. The map was prepared in accordance with G. S. 47-10 and 47-11. Witness my hand and seal this 25<sup>th</sup> day of May, 1995.  
Robert Barry Butler  
Surveyor  
Reg. No. L-3033



LEGEND:  
EIP EXISTING IRON PIN  
EIR EXISTING IRON ROD  
NIR NEW IRON ROD  
R/W RIGHT OF WAY

NOTE:  
THIS PROPERTY IS NOT LOCATED IN A SPECIAL FLOOD HAZARD AREA AS DETERMINED BY THE DEPARTMENT OF HOUSING AND URBAN DEVELOPMENT.

**BENJAMIN E. & JOYCE A. HINES**

GREEN CREEK TWP., POLK CO., NO. CAR.

LEGAL REFERENCE: D.B. 198 P. 102

SCALE: 1" = 200' 24 MAY 1995

BUTLER ASSOCIATES

REG. LAND SURVEYOR L-3033

TRYON, NO. CAR.